



## 6<sup>inches</sup> / 60 Cells

Premium modules of GRAND GROUP series with varied power ratings are suitable for all types of systems from small-scale private roof systems to large-scales power farms.



**Higher Module Efficiency**  
10% more power than standard modules, due to advanced the PERC technology



**More Energy Yield**  
Better temperature coefficient, helps boost energy yield



**Approved Technology**  
Approved practice for different operating conditions



**Lower Operation Temperature**  
Less hot spot heating risk, make the module more reliable



**Aesthetic Design**  
Uniformity appearance, aesthetic design with black frame option

Insured by **Munich RE** 

25 Years Product Warranty / 25 Years Performance Warranty



# 6<sup>inches</sup> /60 Cells

## MONO

Grand Group Australia PTY LTD  
TEL: 1800 961 712  
WEB: [www.grandgrouppaustralia.com.au](http://www.grandgrouppaustralia.com.au)  
Germany Technology Australia Warranty

STC	GM275-60	GM280-60	GM285-60	GM290-60	GM295-60	GM300-60	GM305-60
Maximum Power (P <sub>max</sub> )	275W	280W	285W	290W	295W	300W	305W
Open Circuit Voltage (V <sub>oc</sub> )	38.52V	38.80V	39.08V	39.34V	39.61V	39.88V	40.16V
Short Circuit Current (I <sub>sc</sub> )	9.19A	9.27A	9.35A	9.43A	9.51A	9.60A	9.68A
Voltage at Maximum Power (V <sub>mpp</sub> )	31.58V	31.86V	32.14V	32.41V	32.67V	32.95V	33.23V
Current at Maximum Power (I <sub>mp</sub> )	8.71A	8.79A	8.87A	8.95A	9.03A	9.11A	9.18A
Module Efficiency (%)	16.9%	17.2%	17.5%	17.8%	18.2%	18.5%	18.8%

STC: Irradiance 1000 W/m<sup>2</sup>, module temperature 25 °C, AM=1.5;

Mechanical Characteristics	
Solar Cell	Mono-Crystalline, 6' inch
No. of Cells	60pcs (6×10)
Dimensions	1640×991×35mm
Weight	18.2kg
Front	3.2mm Tempered Glass
Frame	Anodized Aluminium Alloy
Junction Box	IP67, 3 Bypass Diodes
Connectors	Jiaming:PV-JM601,Renhe:05-6
Output Cables	1000mm

Operating Module Temperature	-40°C~+85°C
Maximum System Voltage	1000V
Maximum Series Fuse Rating	15A
Power Tolerance	±3%
Temperature Characteristics	
Nominal Operating Cell Temperature (N <sub>oCT</sub> )	42±3°C
Temperature Coefficient of P <sub>max</sub>	-0.40%
Temperature Coefficient of V <sub>oc</sub>	-0.31%
Temperature Coefficient of I <sub>sc</sub>	0.05%
Packing Configuration	
Container	40HQ
Pieces per pallet	30
Pallets per container	28
Pieces per container	840

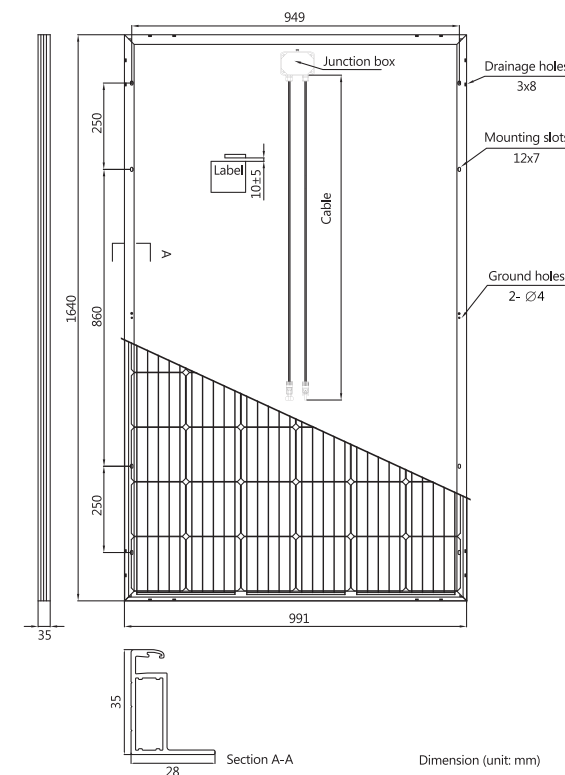

Dimension (unit: mm)